

Emergency Fire Routes for Elementary School

Music, 205, 200A, 200B

Exit the north doors to the black top.

Computer Lab, Media Center

Exit the north doors to the black top.

Rooms 110, 111, 112

Exit the west doors and follow the sidewalk to the front of the scout houses.

Rooms 102, 103, 104, 105

Exit east doors and follow the sidewalk to the pump house.

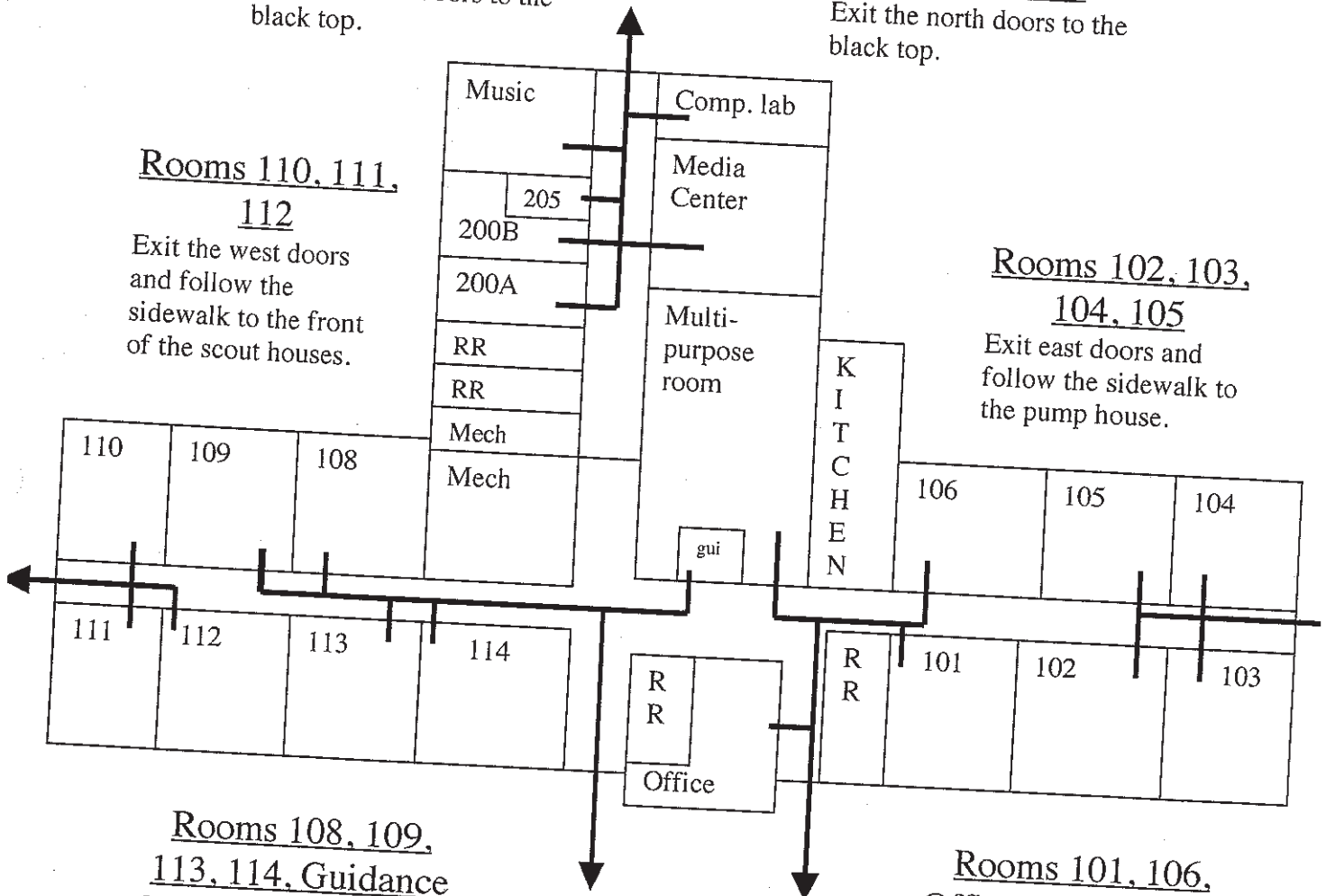

Rooms 108, 109, 113, 114, Guidance

Exit out the center doors (west) and follow the sidewalk around to the front of the scout houses.

Rooms 101, 106, Office, Multipurpose Room

Exit out the center doors (east) and follow the sidewalk around to the sidewalk that leads to the pump house.

1. Exit the rooms following the escape routes. If routes are blocked by either smoke or flames, alternate routes will need to be found. Close doors upon evacuating the rooms.
2. Take roll and immediately alert administration if a student is missing. Staff members should not return to the building to find missing students.
3. Staff and students should remain in "safe zones" until an all clear signal is given or evacuation plans are made by administrative personnel.