

# Emergency Fire Evacuation High Building

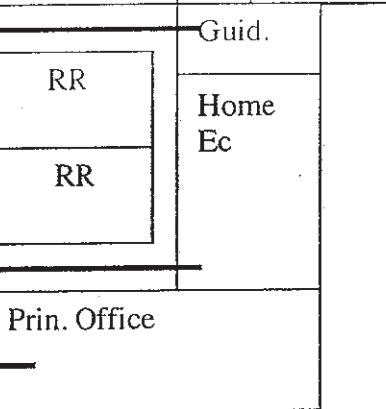

Rooms 105, 106, Media Center  
Exit West Doors (middle) and meet at the curb.

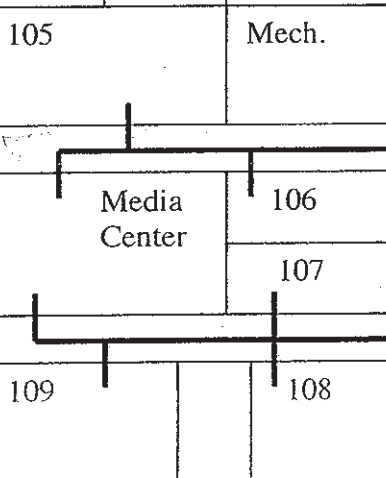
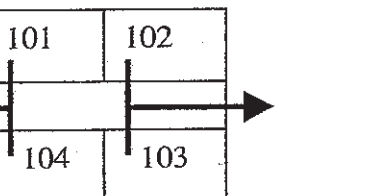
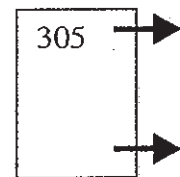
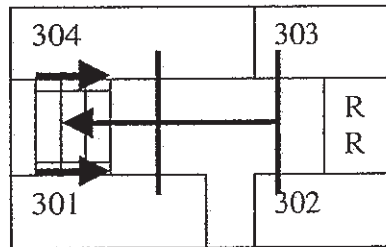
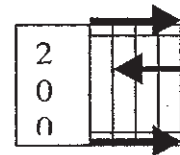
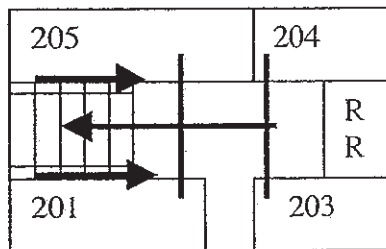
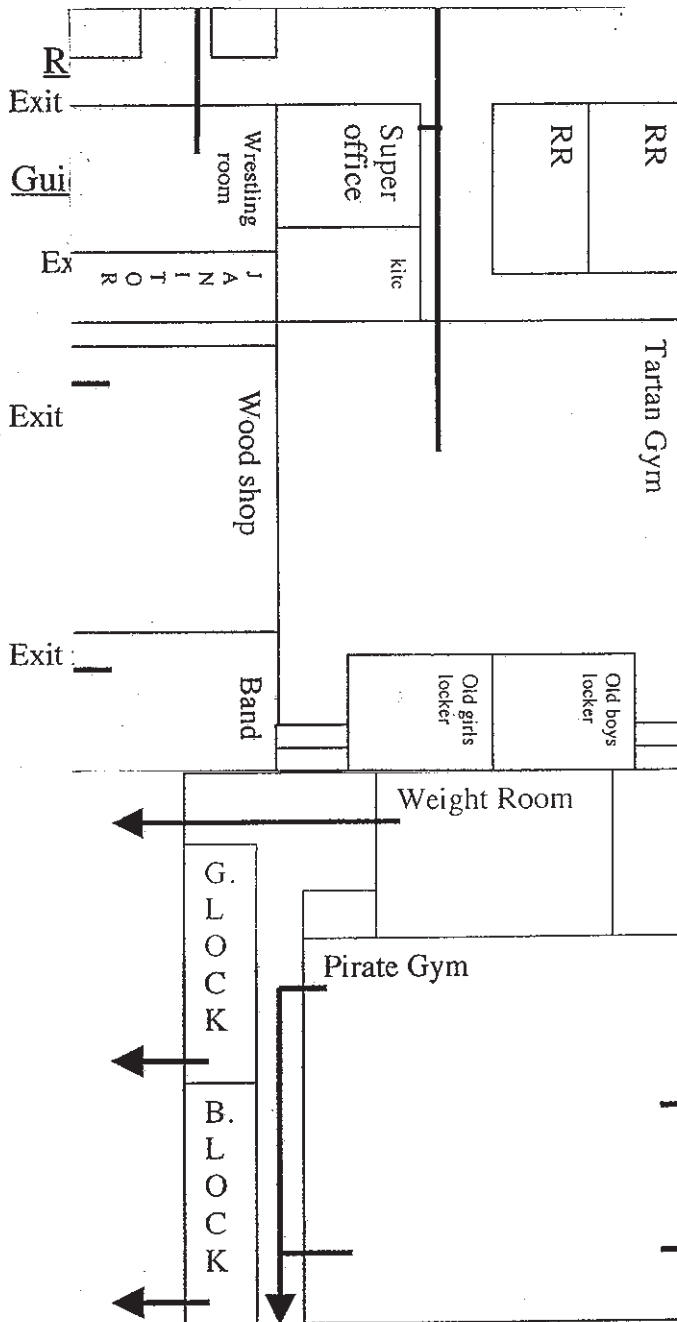

1. Exit the rooms following the escape routes. If routes are blocked by either smoke or flames, alternate routes will need to be found. Close doors upon evacuating the rooms.
2. Take roll and immediately alert administration if a student is missing. Staff members should not return to the building to find missing students.
3. Staff and students should remain in "safe zones" until an all clear signal is given or evacuation plans are made by administrative personnel.