

ERATE 470 FORM #180010466
REQUEST AND
REQUEST FOR PROPOSAL (RFP) FOR:
Plainview Public Schools

PLAINVIEW PUBLIC SCHOOLS is seeking proposals for the upcoming Funding Year 18-19 round of E-Rate. PPS is soliciting proposals for the purchase and installation of network electronics. All services are to be completed within the guidelines and regulations for local, state, and the federal E-rate program.

SERVICES AND HARDWARE REQUESTED:

- **UPS, Network Switches, and Fiber Network Cabling.**

The high school building currently has 1 MDF location and 1 IDF location. The MDF is located in the Long Distance Learning Room 101, which also has the telco demarcation. A larger IDF is located in between two classrooms, 108 and 109, and connects to the MDF via copper Ethernet.

The elementary building consists of 1 IDF located in the media center, which feeds back to the larger IDF via fiber optic cable. This cable needs to be replaced.

The successful bidder(s) will be responsible for qualifying for and adhering to the Federal E-Rate program. Items not eligible for E-Rate must be itemized in the bid. Prices must be held firm for the duration of the E-Rate Year. These projects and services depend on partial funding from the E-rate program and should be completed within the funding year.

- **Applicant expects each Service Provider to make themselves thoroughly familiar with any rules or regulations regarding the E-rate program.**
- **All contracts entered into as a result of this RFP will be contingent upon the specific funding of the FRN at the percentage rate submitted.**
- **The maximum percentage the Applicant will be liable for is the pre-discount amount minus the funded amount or ineligible portion as shown on the form 471 Block 5.**
- **In the event of questions during the E-Rate PIA review process, the successful vendor is expected to reply within 3 days to questions associated with their proposal.**
- **The contractor is responsible for providing a valid SPIN (Service Provider Identification Number) at the time the bid is submitted.**

- Any potential bidder found to be in Red-Light Status will be disqualified from participation in the bidding process and will be considered non-responsive.
- Vendor understands that they may be asked to work around school schedules to avoid impacting classroom or busy office times.

The Applicant reserves the right to deny any or all proposals associated with this RFP, even with SLD funding approval. Applicant reserves the right to consider existing piggyback, open RFP, open 470, etc....

Failure to follow the above criteria and requirements may be considered grounds for disqualification.

Proposals must be addressed to our office location noted below.

Technology Coordinator
Plainview Public Schools
301 West Pilcher Avenue
P.O. Box 638, Plainview, Nebraska 68769
Telephone: 402.582.4993

PROJECT

This proposal should be a turn key option:

- 1) Full proposal (hardware and labor) to include:
 - a) Vendor to propose and coordinate configurations with SCS prior to installation, in order to provide a "turn-key" delivery. This includes, but not limited to, configuring (per SCS specification) equipment naming, IP addresses, protocols, NTP servers, SNMP settings, etc...
 - b) Install the specified network electronics equipment into provided or project included wall mounted or freestanding electronic equipment racks.
 - c) Perform power-on system and functionality tests.
 - d) Perform and demonstrate a verification of network connectivity and functionality.
 - e) Verify access to the Internet and to SCS resources
 - f) Provide documentation listing all equipment, part numbers, quantities, serial numbers, IP addressing and equipment naming.

HARDWARE EQUIPMENT

FIBER NETWORK CABLING EQUIPMENT:

All fiber network wire should be 10 Gbps rated or better with compliant SC type accessories used. For example SFP+ modules UF-MM-10G.

NETWORK SWITCHING EQUIPMENT:

Must have such design to integrate seamlessly with existing head-end and downstream equipment. All switches must be minimum Gigabit at all ports, be able to provide POE+ and SFP+ capabilities. For example, SFP+ modules UF-MM-10G used in ES-48-750W at either end of the installed fiber network cable.

UPS (UNINTERRUPTIBLE POWER SUPPLY):

Each distribution frame must have a UPS with enough capacity to provide at least 30 min of runtime at the current equipment load.

Evaluation Procedures

The evaluation will be performed by the RFP Coordinator and evaluation staff for services proposed. The evaluators will consider how well the vendor's proposed solution meets the needs and criteria set forth in the fair and competitive bidding process using the below matrix. It is important that bids be itemized, clear, and complete so that the evaluators can adequately understand all aspects of the proposal. Evaluation results are confidential and the property of SCS.

Evaluation Scale:

Factor	Weight
Price of Eligible Goods and Services	30%
Walkthrough	20%
Qualifications	15%
Prior Experience	15%
Distance from District	10%
Bill Methods	5%
E-rate Experience	5%

Plainview Public Schools Aerial View



Plainview Public Schools Elementary School Floor Plan

Emergency Fire Routes for Elementary School

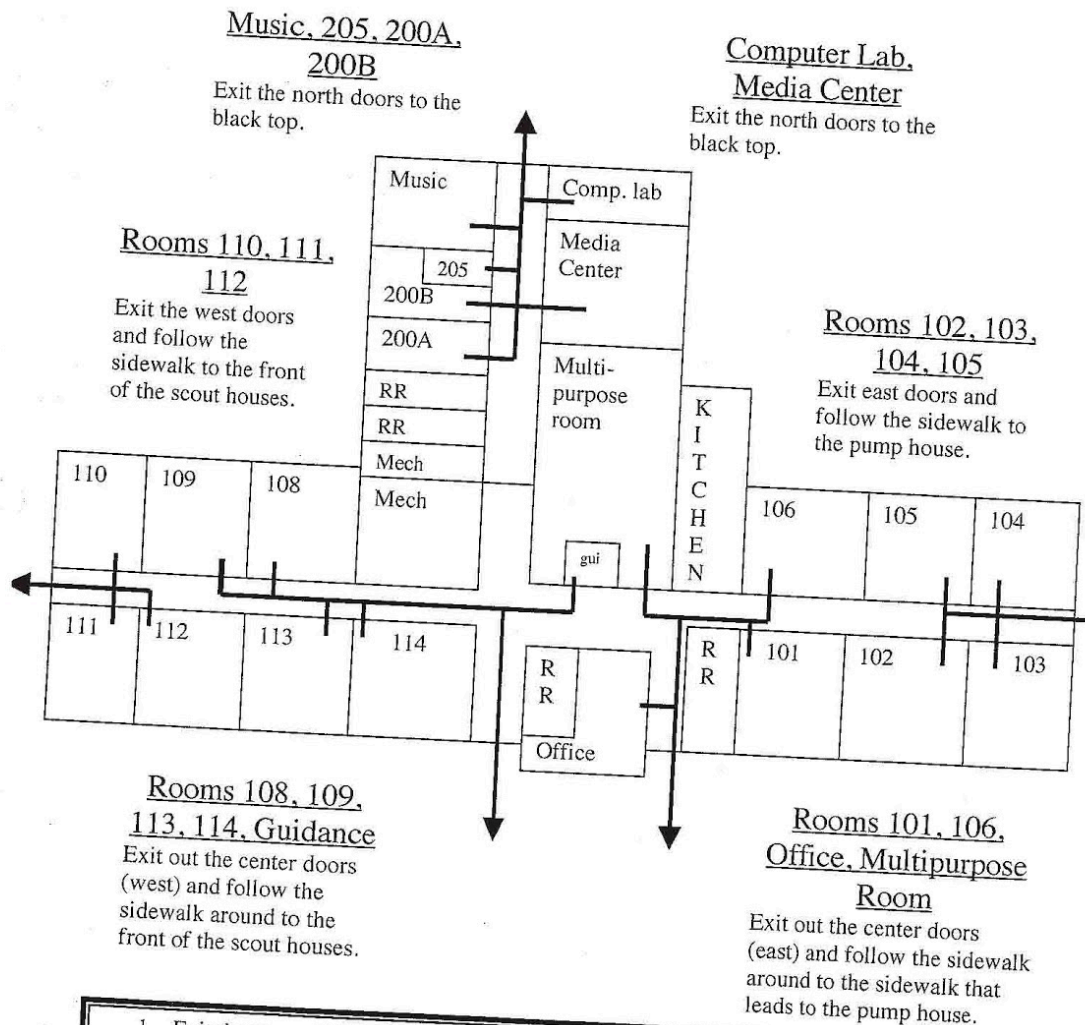

1. Exit the rooms following the escape routes. If routes are blocked by either smoke or flames, alternate routes will need to be found. Close doors upon evacuating the rooms.
2. Take roll and immediately alert administration if a student is missing. Staff members should not return to the building to find missing students.
3. Staff and students should remain in "safe zones" until an all clear signal is given or evacuation plans are made by administrative personnel.

Plainview Public Schools High School Floor Plan

Emergency Fire Evacuation High Buil

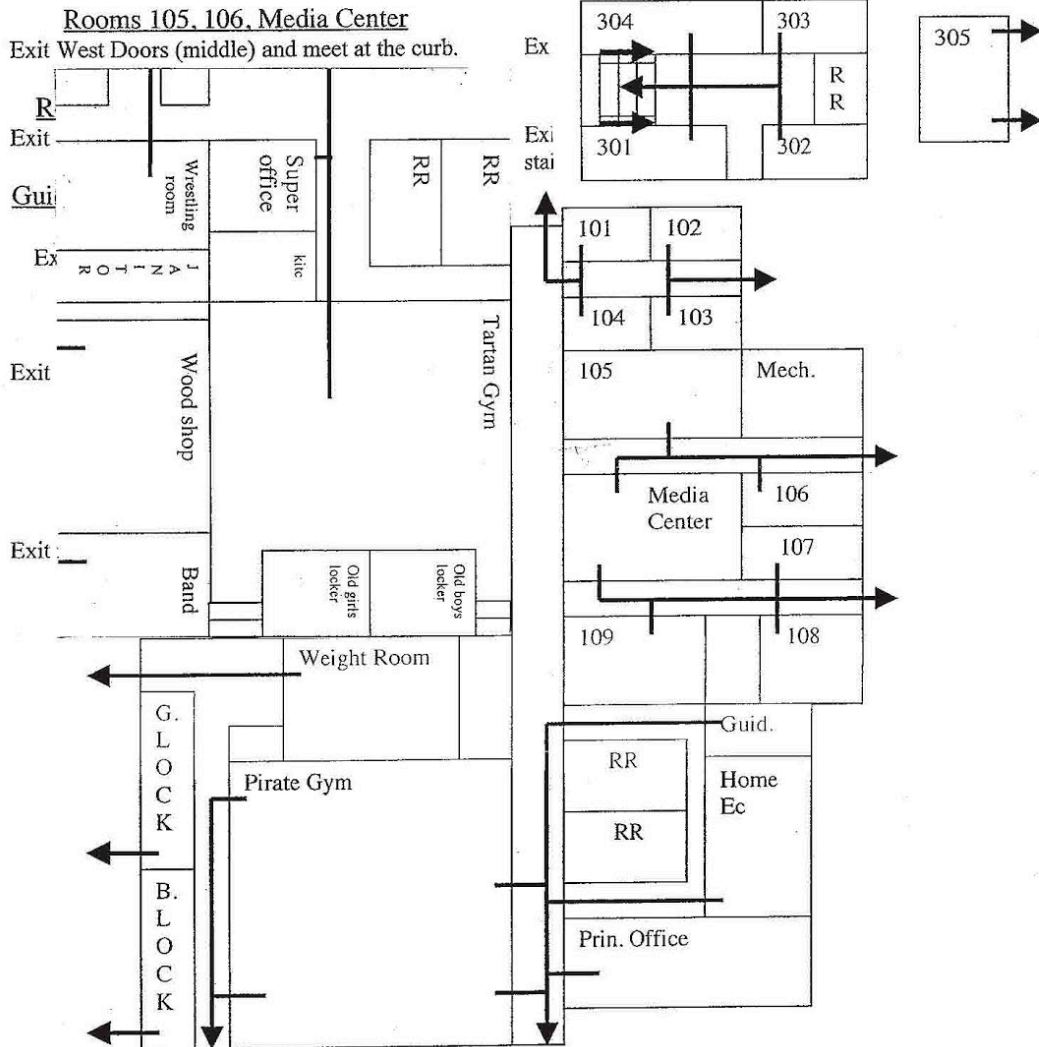

1. Exit the rooms following the escape routes. If routes are blocked by either smoke or flames, alternate routes will need to be found. Close doors upon evacuating the rooms.
2. Take roll and immediately alert administration if a student is missing. Staff members should not return to the building to find missing students.
3. Staff and students should remain in "safe zones" until an all clear signal is given or evacuation plans are made by administrative personnel.